



~ DOWN PAYMENT ASSISTANCE

~ FIXED INTEREST RATES

~ LET US HELP YOU DETERMINE YOUR ELIGIBILITY!!!

Elegant & Spacious Townhome in Established Southside Gated Community

www.yorktownplace.com

400 Tibet Avenue, Savannah, GA 31406

Unit #19: \$124,900 (The Princeton) 2 Beds with 2 1/2 Baths Townhome 1,281 sq. ft.	Base Model: \$120,000 (The Princeton) 2 Beds with 2 1/2 Baths Townhome 1,281 sq. ft.	Base Model: \$139,500 (The Trenton) 3 Beds with 2 1/2 Baths Townhome 1585 sq. ft.
--	--	---



Seller's Info

Chris Frame
Tibet Investors, LLC
(912) 484-1171
cframe@mindspring

Property Features

- 2 or 3 bedrooms
- 2 full bathrooms + 1 half bathroom
- Stainless steel appliances
- Private fenced patio
- Open, modern floor plans
- Reserved parking spaces
- Professionally landscaped
- Gated, Secure community
- Contemporary 2 story style
- New Construction
- High efficiency appliances
- Lots of storage with floored attic
- HOA Dues: \$90 (per month)
- Upgrades available

Property Description

Fantastic opportunity to purchase in this well established, gated, town home community. Designer colors. Open Kitchen. Modern layout! Two-level town home

Close to all universities, hospitals, HAAF, and malls.

WALK-IN closets and 9 FT CEILINGS with carpeting and laminate hard woods.

Floored attic for extra storage with generous storage on all levels.

New construction, windows, roof, etc...! True town home community on the Southside!

912-484-1171 cell cframe@mindspring.com www.yorktownplace.com



~ DOWN PAYMENT ASSISTANCE

~ FIXED INTEREST RATES

~ LET US HELP YOU DETERMINE YOUR ELIGIBILITY!!!

400 Tibet Avenue #19, Savannah, GA 31406 2 Bedroom/ 2.5 Bath \$124,900 (The Princeton)

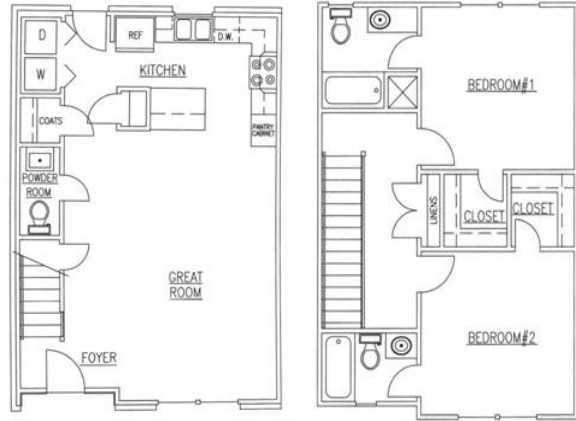

912-484-1171 cell

cframe@mindspring.com

www.yorktownplace.com

400 Tibet Avenue #19, Savannah, GA 31406 2 Bedroom/ 2.5 Bath \$124,900 (The Princeton)



912-484-1171 cell cframe@mindspring.com www.yorktownplace.com